



# Matrix Integrates Tax Data

## MATRIX AND REALIST®, TOGETHER AT LAST

### Matrix, the Leading Multiple Listing Platform, Just Got Better.

The latest Matrix update brings together two of the most popular solutions in their respective categories: Matrix and the Realist® property information system.

### Benefits

- **Save time.** Leverage Realist data without launching a separate program and leaving the MLS workflow.
- **It's familiar.** Create searches, get results, view details, print and email reports for both listing and tax records, all in one place, all in the same way.
- **Better technology.** The Matrix interface lets you access both listing and property data from virtually any device—no plugins required.

### Highlights

- **A tax search** is now available within Matrix.
- **Complete property display** includes listing data, tax/assessment data, transaction/document history, area schools, flood data, and more. You can also choose which content to print.
- **Interactive maps** now display brief tax and listing information on the parcel where data is available. You also have one-click access to the full reports.
- Within the full property display, you can **zoom and pan, switch between street and satellite views, enable layers,** and click on parcels to view neighboring property information.
- **Comprehensive map overlays** include flood, highlighted parcel, lot dimensions, valuations, sales activity, foreclosure activity, and more. Flood zone information was available for a fee prior to this update, but now it's free.
- **The combined history** shows all listing activity for the property, as well as sale, mortgage and foreclosure history from public records, conveniently in one place.
- **Print mailing labels** from tax data.

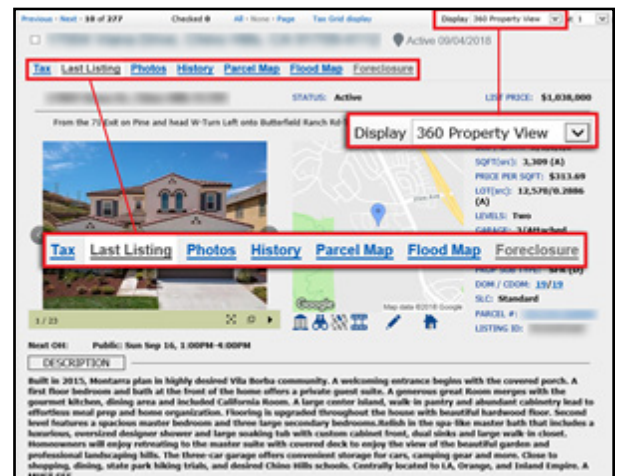

New default view

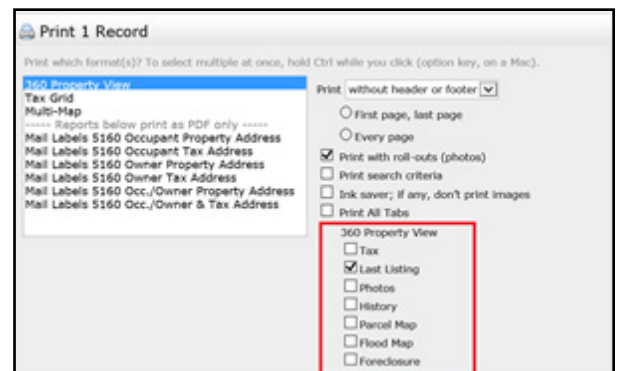

Choose which content to print